



FALL 2021 NEWSLETTER

MESSAGE FROM THE HEAD OF THE SCHOOL OF CIVIL AND ENVIRONMENTAL ENGINEERING

A little late, but welcome to 2022. The School is forging ahead. While we have had small dips in new students and enrollments, the numbers are bouncing back, and our graduates remain in very high demand.

Join us on [LinkedIn](#) to keep up with departmental news.

If you have items to suggest for our next newsletter, please email them to me.

Norb Delatte
 Phone: 405 744 5190
 Email: norb.delatte@okstate.edu

CONGRATULATIONS TO OUR FALL 2021 GRADUATES!



BSCE

Buzan, Nathan
 Caldwell, Joshua
 Collier, Jeffrey
 Evans, Lukas

Ferguson, Cade
 Henke, Geoffrey
 Irby, Isaiah
 Kennerly, Joshua

Long, Elizabeth
 McGregor, Megan
 Moriarty, Jacob
 Olansen, Jackson

Riggione, Brian
 Ross, Adam
 Slayter, Jackson
 Taber, Logan

Warner, Zachary
 Weltzheimer, Jordan
 Wiseman, Dawson

MSCE/EVEN

Boyd, Braden

Minnekanti, Meghana

Ph.D.

Wang, Xuewen

OSU CIVE SENIOR DESIGN PARTNERS WITH ENGINEERS WITHOUT BORDERS USA COMMUNITY ENGINEERING CORPS ON A PROJECT IN SAMBURG, TENNESSEE



A rural community in eastern Tennessee is seeking assistance to prepare preliminary engineering designs for a water storage solution for a town of 350 customers. Their current system configuration is such that water is delivered to a steel storage tank residing on a hillside on the S/E border of the town. Due to a number of factors, the storage tank on the hillside adjacent to the town is approaching a point of critical failure, and the hillside is increasingly losing stability. Emergency repairs were conducted a few years ago during a period where the tank was in the midst of an active failure, and these repairs were intended to be temporary while an alternative storage solution was designed. Dr. Wilber and Dr. Delatte took a team of students on a site visit in November 2021, and another team is continuing the project in the spring semester. Engineers from Garver are assisting with the project. Special thanks to Kevin Mullins, from Garver's Huntsville, Alabama office, who accompanied us on the site visit.

WELCOME TO NEW FACULTY



Dr. Mary Foltz joined the School of Civil and Environmental Engineering at Oklahoma State University as an assistant professor in August 2021. She previously obtained her doctorate in environmental engineering from the University of Illinois Urbana-Champaign. Her research focuses on agricultural nutrient loss, passive treatment systems for biogeochemical water treatment, and greenhouse gas emissions. Her work aims to incorporate multiphase contaminant transformations and use a combination of field, lab, and modeling at different scales to accomplish research goals.



Dr. Mohamed Elkashef joined the School of Civil and Environmental Engineering at Oklahoma State University as an assistant professor in August 2021. He previously worked as an associate research scientist at the University of California, Davis. Mohamed has earned a doctorate in civil engineering from Iowa State University, and a doctorate in structural engineering from Cairo University in Egypt. His research focuses on pavement materials with particular emphasis on the performance of asphalt pavements, asphalt binder modification, pavement recycling, and the application of sustainable pavement technologies.

CIVE ALUMNUS NEAL A. MCCALED HONORED AS A TAU BETA PI DISTINGUISHED ALUMNUS



Mr. McCaleb addressing the OSU Tau Beta Pi chapter. Click photo for more details.

NEW ENVIRONMENTAL ENGINEERING MINOR APPROVED

The school will now be offering a minor in environmental engineering, open to students in civil engineering as well as other students in appropriate STEM majors. Dr. Mark Krzmarzick is the program director.

INTERNATIONAL OUTREACH

We have partnered with Study International to recruit around the world for our programs. You can read the article here:

<https://studyinternational.com/news/oklahoma-state-university-impactful-engineers-in-industry-and-research/>

The article is getting interest from India, Ghana, Nigeria, Kenya, Colombia, Peru, Argentina, and other countries.

SENIOR DESIGN SUSTAINABILITY WORKSHOP

Thanks once again to the team from Freese and Nichols for giving the sustainability workshop to our senior design students. This is an important part of integrating sustainable engineering into our curriculum.



FOUNDATION UPDATE

The Civil and Environmental Engineering Fund (26-66000) is probably our single-most important fund. This is the general purpose fund that we can use to support all of our departmental initiatives. This fund supports:

- Recognition of our graduates, which traditionally includes the senior dinner and the Cowboy Hard Hats and safety vests
- Support to student clubs and organizations
- The Engineering North renovation project, as well as furniture and other enhancements for the new spaces
- Study abroad travel scholarships
- Supporting our efforts to recruit high quality faculty for the program

Therefore, I would like to ask you to help us out with that fund. Through summer 2019, the school has awarded over 3,000 BSCE degrees. If half of our graduates gave just \$50 every year, that would provide \$75,000 to support these efforts.

Opportunities remain to support the Engineering North 2nd Floor Renovation Project. The figure below shows the spaces that have been named in gray. There are several faculty offices and other spaces that you can sponsor.

Did you know?... You can make a bigger impact by donating long-term appreciated securities (like stock, bonds or mutual funds) directly to the OSU Foundation. Compared with donating cash or selling your appreciated securities and contributing the after-tax proceeds, you may be able to automatically increase your gift and your tax deduction by bypassing capital gains while you take a tax deduction for the full fair market value.

CIVIL & ENVIRONMENTAL ENGINEERING

Engineering North 2nd Floor Renovation

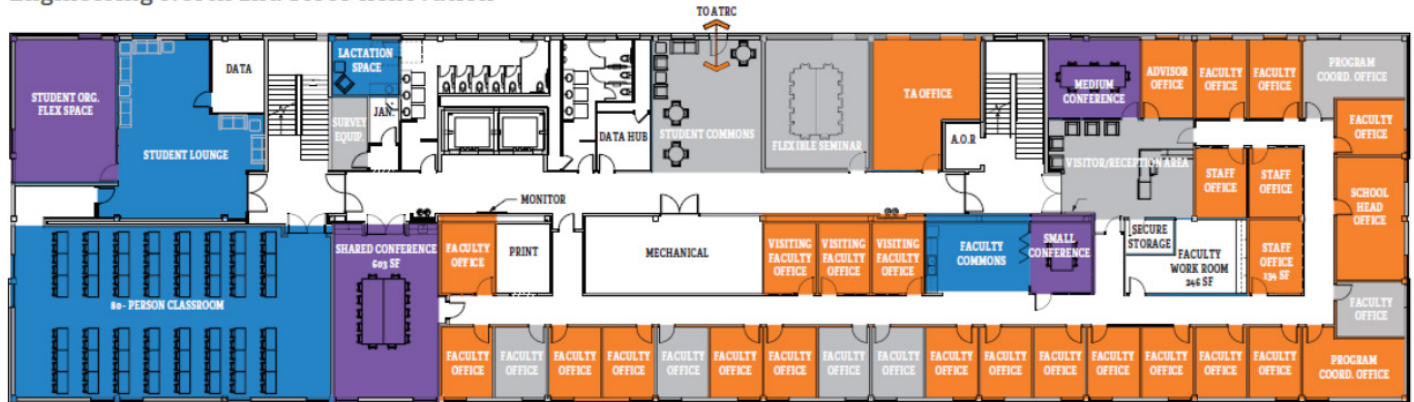

Naming Opportunities

School | \$20M

Chair | \$1M

Professorship | \$500,000

Office Spaces

School Head Office | \$30,000

Advisor Office | \$10,000

Staff Office (3) | \$10,000

Visiting Faculty Office (3) | \$10,000

Faculty Office (16) | \$10,000

Program Coordinator Office (1) | \$15,000

TA Office | \$30,000

Conference Rooms

Shared Conference | \$100,000

Flexible Seminar | NAMED

Student Org. Flex Space | \$40,000
Conference Room - Medium | \$30,000
Conference Room - Small | \$20,000

Meeting Spaces

Student Commons | NAMED

Visitor/Reception Area | NAMED

Faculty Commons | \$25,000

Lactation Space | \$10,000

80-Person Classroom | \$250,000

Student Lounge | \$75,000

Survey Equipment Room | NAMED

How to Give

- Go to OSUgiving.com/CIVE
- Complete the secure, online form

For more information contact Jill Johnson at jjohnson@OSUgiving.com or 405.385.0733.

NEW FUND AGREEMENTS

We had a number of new funds created in 2021, all to support students with scholarships and fellowships. Thank you so much to these generous donors.

FY 2021

- Jon and Glenda Nelson Endowed Scholarship in CIVE
- Myron and Judy Hayden Endowed Scholarship in Civil and Environmental Engineering
- William L. "Bill" Harris Endowed Scholarship for Construction Engineering Tech and Civil Engineering
- John and Jean Richardson Endowed Graduate Fellowship in Civil & Environmental Engineering

KEEPING UP WITH THE PROGRAM

Last fall I recorded a new recruiting **VIDEO**

Please pass this on to any potential students for our program.

Do you want to get regular updates on the school? Join our OSU CIVE **LINKEDIN GROUP**

Please support the School of Civil and Environmental Engineering! You can click on the box below:

Payment options -- Please note Fund #26-66000 CIVE on all gifts:

- Check, made out to Oklahoma State University Foundation
-Mail to: OSU FOUNDATION, Attn: Jill Johnson, 400 S. Monroe, Stillwater, OK 74074
- **Give online at OSUgiving.com/GiveNow (Search for Fund #26-66000; Can be one-time or recurring gift)**
- Call the OSU Foundation at (800) 622-4678
- Pledge your naming gift using the attached form





In consideration of my/our interest in supporting the mission of Oklahoma State University, I/we wish to make a gift as outlined below:

\$ _____ total pledge to be designated as follows:

26-66000 Civil and Environmental Engineering Fund

My/our gift commitment will be fulfilled in the following manner:

Total pledge to be paid over _____ years (not to exceed five) as follows:

First pledge payment of \$ _____ to be made on or about _____ (date)

Remaining pledge payments to be made on the following schedule:

_____ annually, beginning on _____ (date)

_____ other _____

Please make check payable to OSU Foundation. A pledge reminder letter will be sent to you prior to each pledge payment date.

All gifts are subject to the allocation of donated funds policy, as set by the Foundation's Board of Trustees. For more information, please visit OSUgiving.com.

_____ I/we wish to remain anonymous.

_____ For gift recognition purposes, please list my/our name(s) as indicated below:

Print Name: _____ Signature: _____ Date: _____

Print Name: _____ Signature: _____ Date: _____

Address: _____

City: _____ State: _____ Zip: _____

You will receive receipts for the tax-deductible portion of your payment itemizing your contribution.

Corporate Matching Gifts

_____ This gift will be matched by my employer, _____.

(Please obtain and complete a matching gift form and send with your gift.)